

Thru Hole Short type, Round Socket Pin

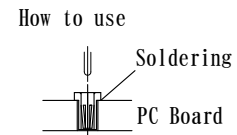

: mm

NV5P-F10L14-GG

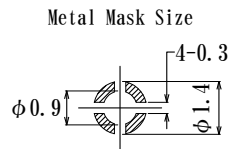
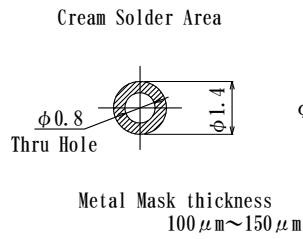
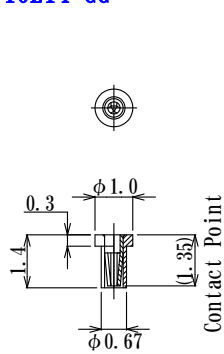

Acceptable Plug dia.
 $\phi 0.18 \sim \phi 0.29$ (NV5)

NV6P-F115L17-GG

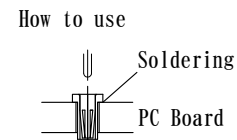
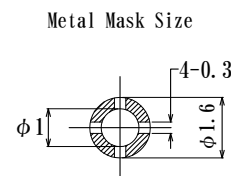
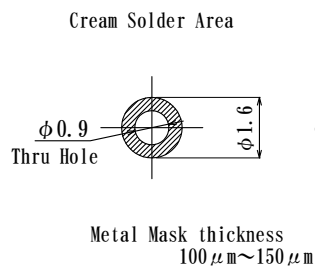
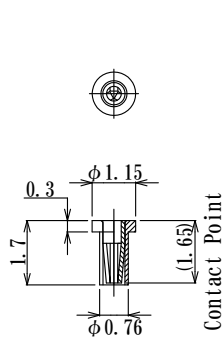

Acceptable Plug dia.
 $\phi 0.21 \sim \phi 0.35$ (NV6)

NV7P-F125L16-GG

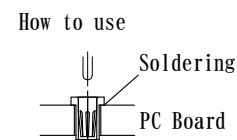
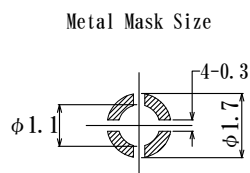
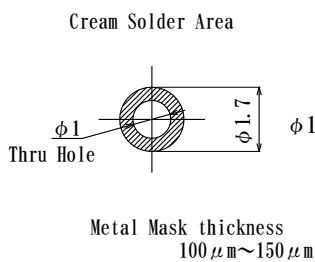
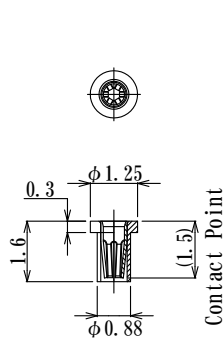

Acceptable Plug dia.
 $\phi 0.21 \sim \phi 0.42$ (NV7)

Thru Hole Short type, Round Socket Pin

: mm

NZP-F135L17-GG

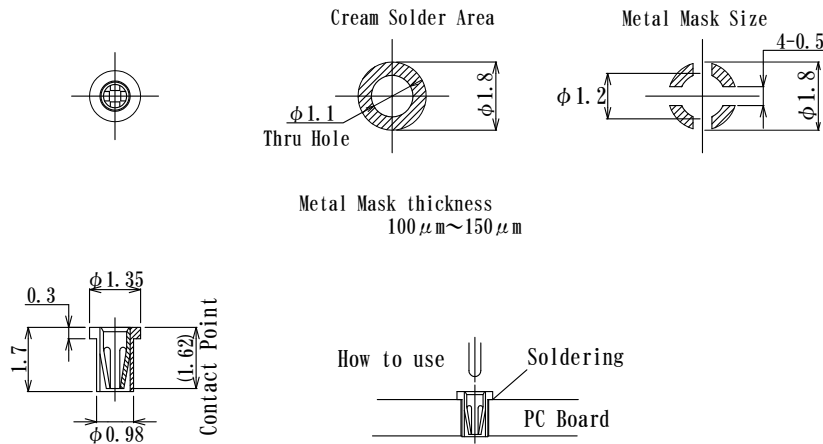

Temperature Rise (Reference)

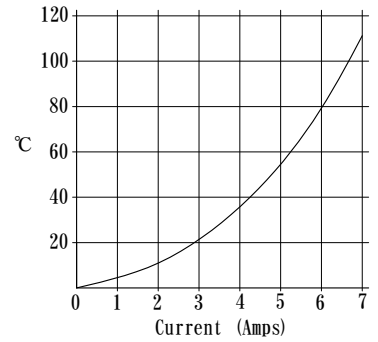

Plug $\phi 0.45/0.018''$
 Brass Au over Ni plating



Acceptable Plug dia.
 $\phi 0.3 \sim \phi 0.52$
 (N-01)

JSS17-GG

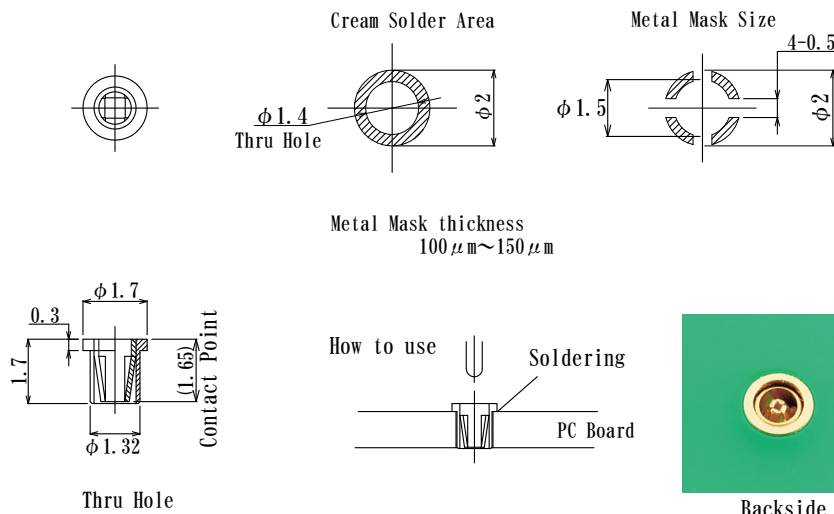

Temperature Rise (Reference)

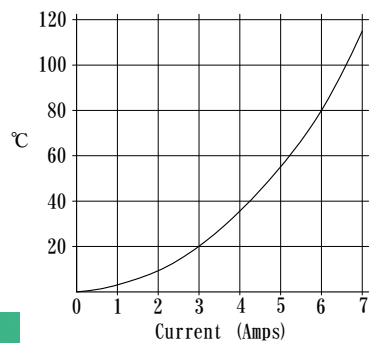

Plug $\phi 0.45/0.018''$
 Brass Au over Ni plating

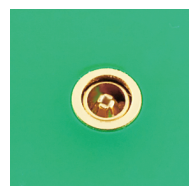

Backside



Acceptable Plug dia.
 $\phi 0.38 \sim \phi 0.6$
 (JV11)

Thru Hole Short type, Round Socket Pin

: mm

866-F19L23-GG

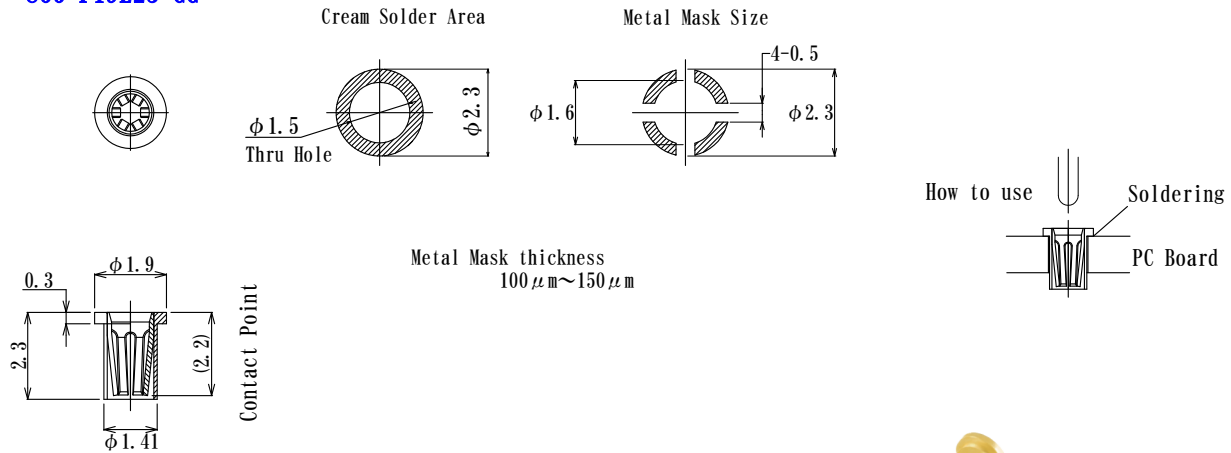

Acceptable Plug dia.
 $\phi 0.65 \sim \phi 0.85$ (866)

CM1-F23L35-GG

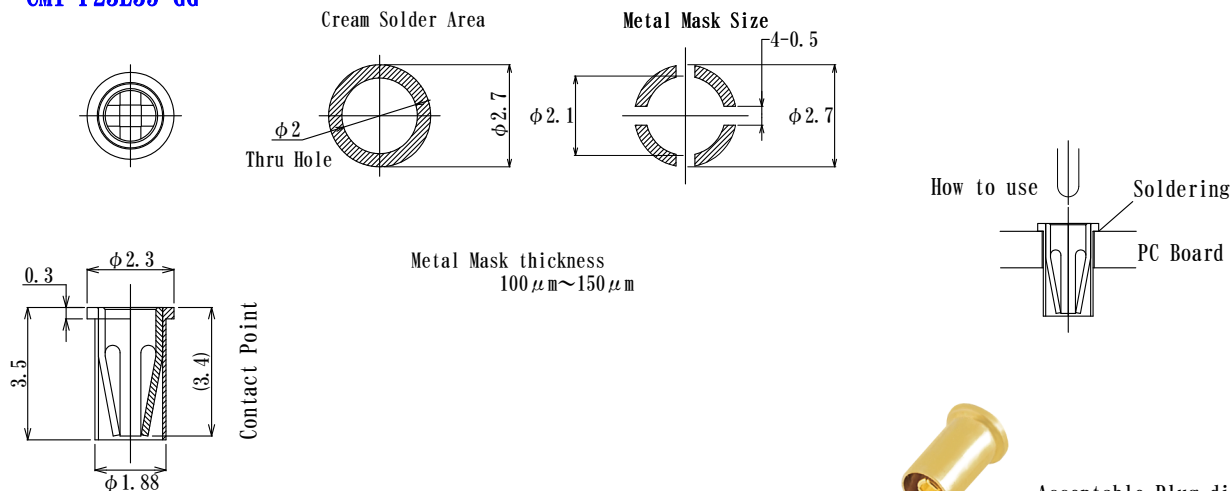

Acceptable Plug dia.
 $\phi 0.7 \sim \phi 1.05$ (CM1)

DPA5P-F23L23-GG

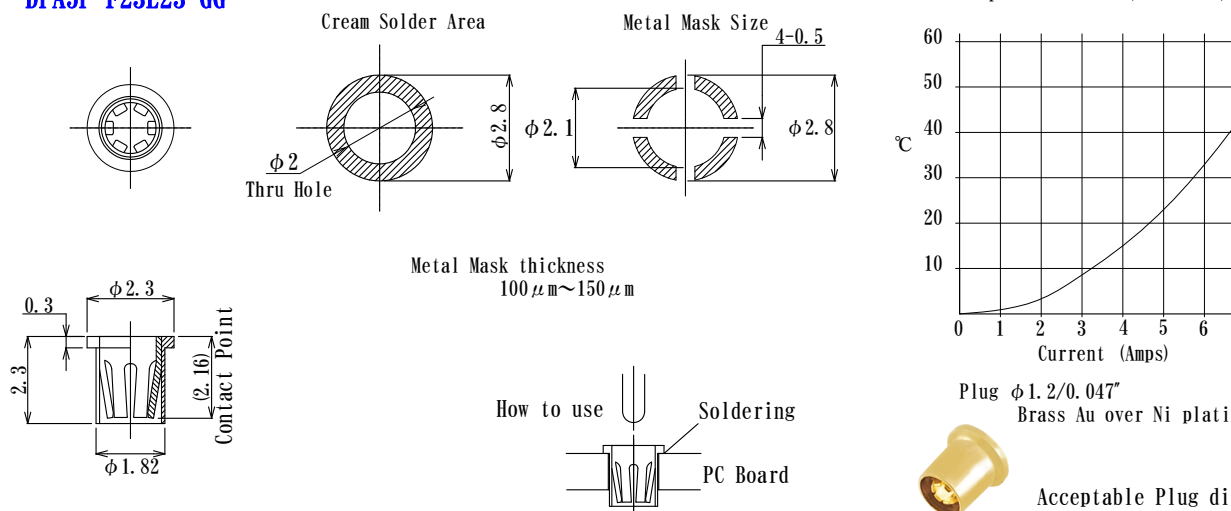

Acceptable Plug dia.
 $\phi 1.0 \sim \phi 1.3$ (DPA-5)