

## Plug $\phi 0.76\text{mm}$ Round pin connector

- Highly reliable round pin contact
- Mount to PC board
- Custom made welcome

### Specification

Dielectric voltage: AC700Vrms 1min  
Insulation resistance: 1000M $\Omega$  min  
Contact resistance: 15m $\Omega$  max  
rating current: 1.0 A  
Temperature range: -55 $^{\circ}\text{C}$  ~ +150 $^{\circ}\text{C}$   
(in case of gold plating)

### Materials

Sleeve: Brass Ni plating over gold plating  
Contact: Beryllium copper Gold plating over Ni plating

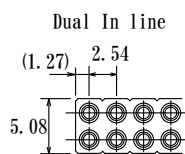
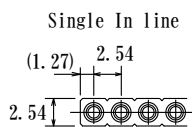
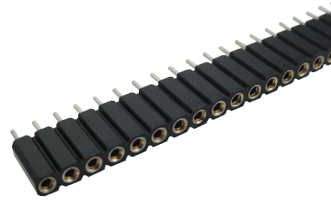

### How to order

**SPDK15-S36-GT**

See below

Number of positions

D: Dual In Line  
S: Single In Line

### Socket

**SPDK15-S36-GT**

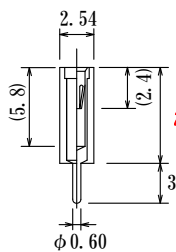

**SPDK15-D72-GT**

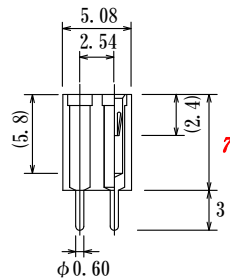

**SPDK15R-S36L-GT**

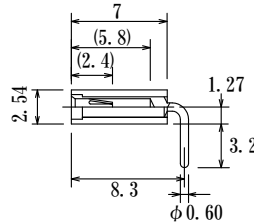

**SPDK15R-D72L-GT**

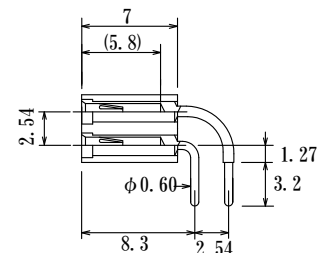

### Plug

**ISL76-S36-G112**

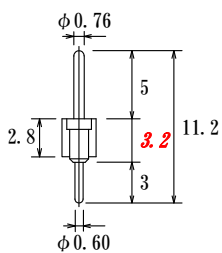

**ISL76-D72-G112**

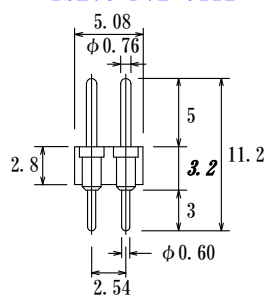

**ISL76-S36L-G112**

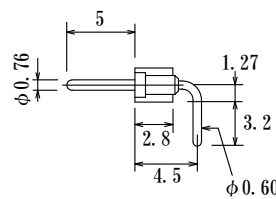

**ISL76-D72L-G112**

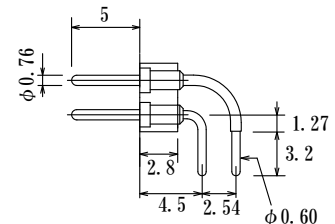

### Mating configuration

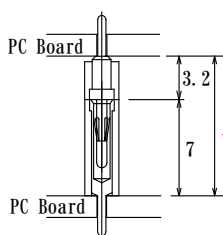

10.2

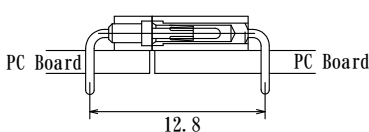

12.8

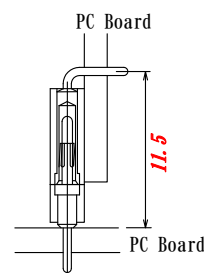

11.5

### How to use

