

Right Angle type, High current Socket pin

- Socket pin right angle to wire
- Space saving
- Mating/unmating, Easy Circuit exchange

φ 5.0mm/0.197" Right Angle Socket

UJ50-RA-L18-CRMP

Current rating : 25A at 25°C



Acceptable plugpin
: φ 5.0mm/φ 0.197" dia.

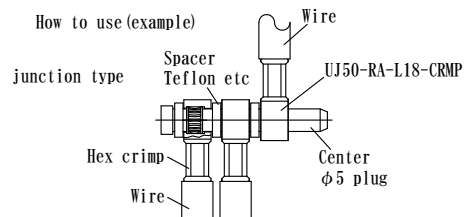
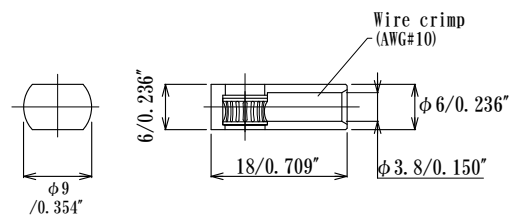
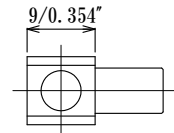

φ 6.0mm/0.236" Right Angle Socket

UJ60-RA-L21-CRMP

Current rating : 50A at 25°C



Acceptable plugpin
: φ 6.0mm/φ 0.236" dia.

