

Plug Socket UJP2 Series

- Highly reliable beryllium copper spring louver
- Low and stable contact resistance by multi contact configuration
- Long durability



UJP2AG

φ 2.0 hole Socket

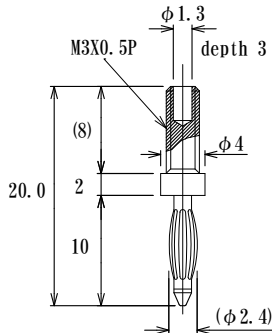

current rating : 18A
(CP-MALE1-1.3X8.0L)

UJP2BG

φ 2.0 hole Socket

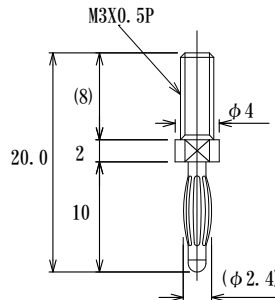

current rating : 18A
(CP-MALE1-1.3X8.0L)

UJP2TG

φ 2.0 hole Socket

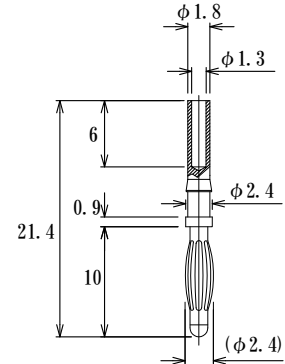

current rating : 18A
(CP-MALE1-1.3X8.0L)

UJP25AG

φ 2.5 hole Socket

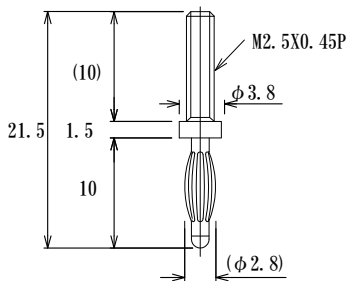

current rating : 18A
(CP-MALE30-8L-2)

UJP25AN-PE

φ 2.5 hole Socket

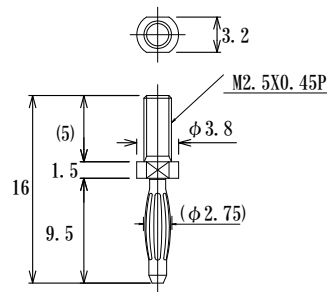

current rating : 18A
(CP-MALE30-8L-2)

UJP2AG-234L-DAI

φ 2.0 hole socket

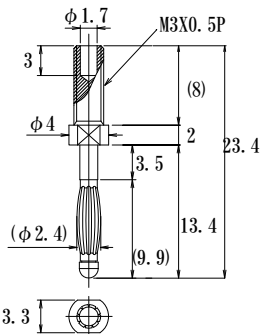

current rating : 18A
(CP-MALE1-1.3X8.0L)

UJS2AG

φ 2.0 hole socket

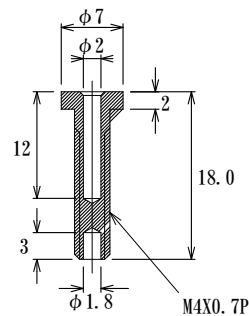

※Suggested torque : 0.784 (N m)

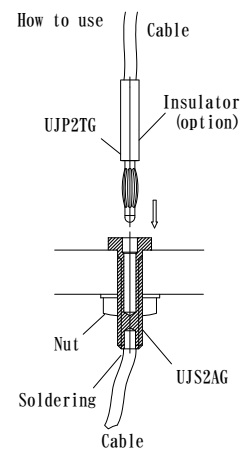

Color Plug Sockets for $\phi 2.0$ Hole

Maximum current value : 10A
Operating Temperature : $-55^{\circ}\text{C} \sim +105^{\circ}\text{C}$

How to order
UJPS2-1011-1-RED

BLK
RED
BLU
YLW
GRN
WHT

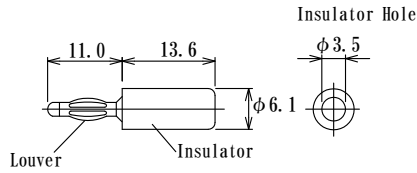

Plug Sockets UJP4 Series

- Highly reliable beryllium copper spring louver
- Low and stable contact resistance by multi contact configuration
- Long durability

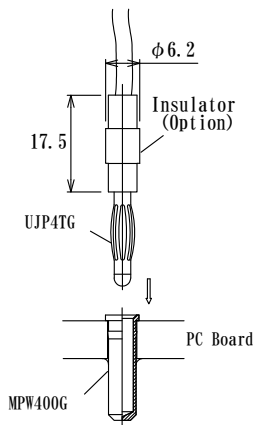

MPW400G

Socket pin
Straight hole

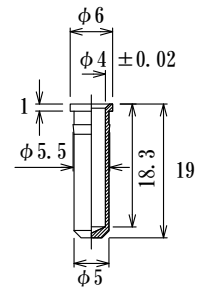

Brass
Gold plating over Ni

UJP4TG

$\phi 4.0$ Applicable hole

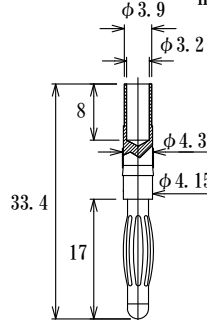

current rating : 30A
(CP-MALE2-14L-T015)

UJP4AG

$\phi 4.0$ Applicable hole

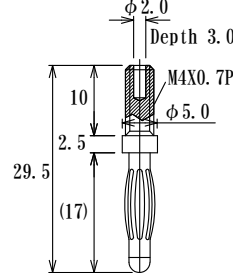

current rating : 30A
(CP-MALE2-14L-T015)

UJP4K400G

$\phi 4.0$ Applicable hole

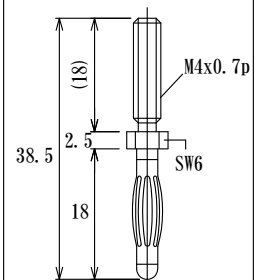

current rating : 30A
(CP-MALE2-14L-T025)